

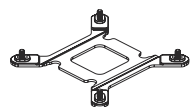

## Parts List

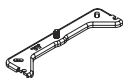

A x 1



B x 2



C x 4



Silver  
D x 4



Silver  
E x 4



Yellow Zinc  
F x 4



G x 4

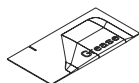

H x 1

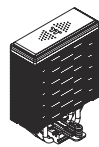

I x 1

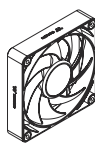

J x 1

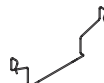

K x 2

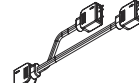

L x 1

## Intel Installation Guide

1

a LGA1200/1156/1155/  
1151/1150  
b LGA1851/1700

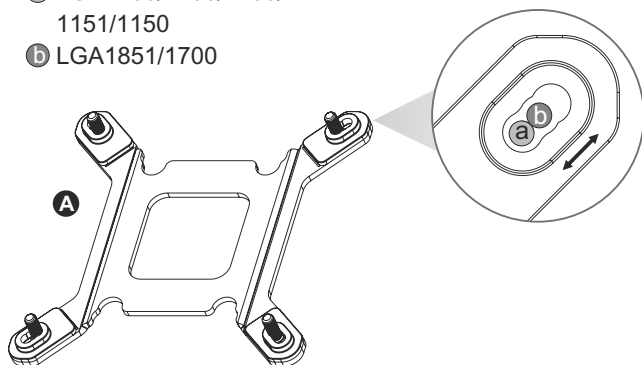

a LGA1200/1156/1155/  
1151/1150  
b LGA1851/1700

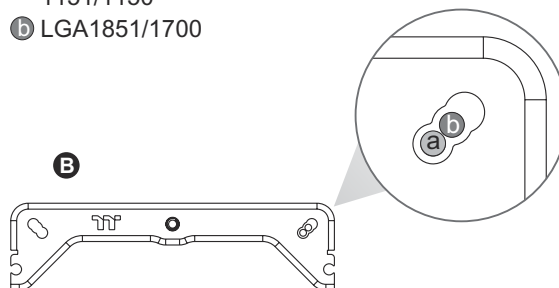

2

LGA1851/1700

or

LGA1200/115X

or

LGA2600/2011

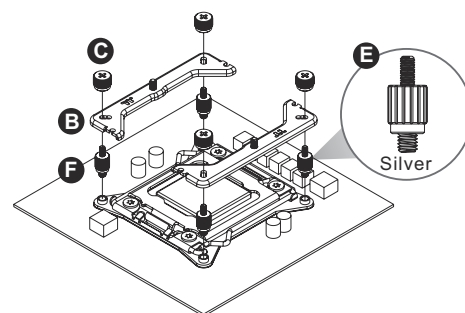
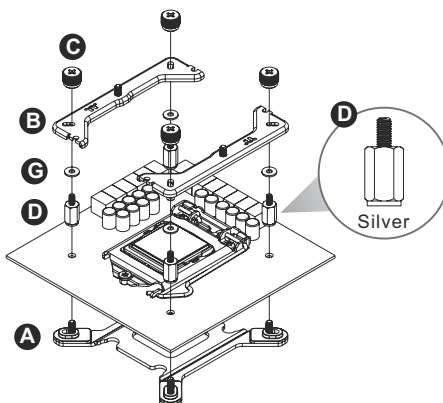
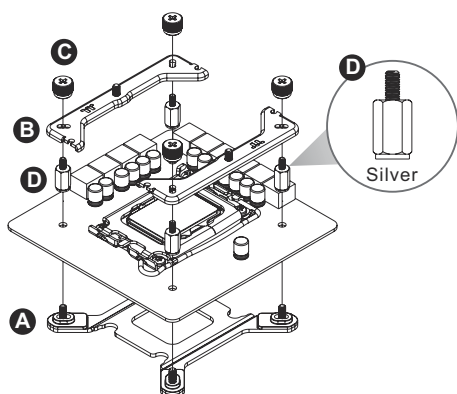

3

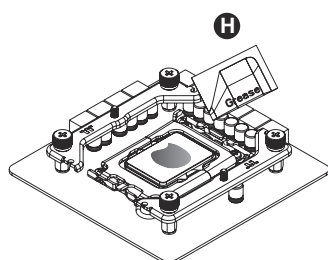

4

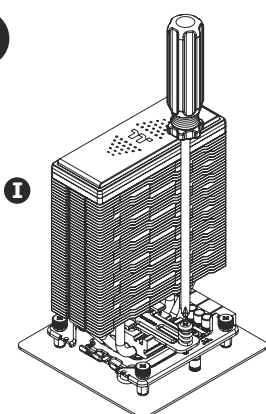

5

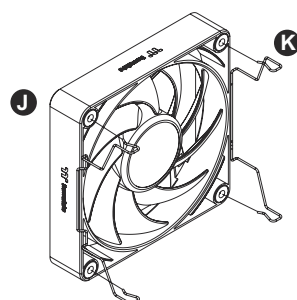

6

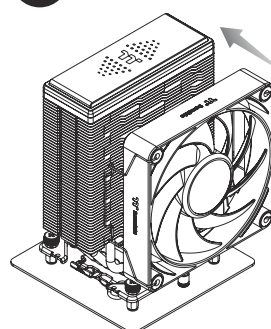

# AMD Installation Guide

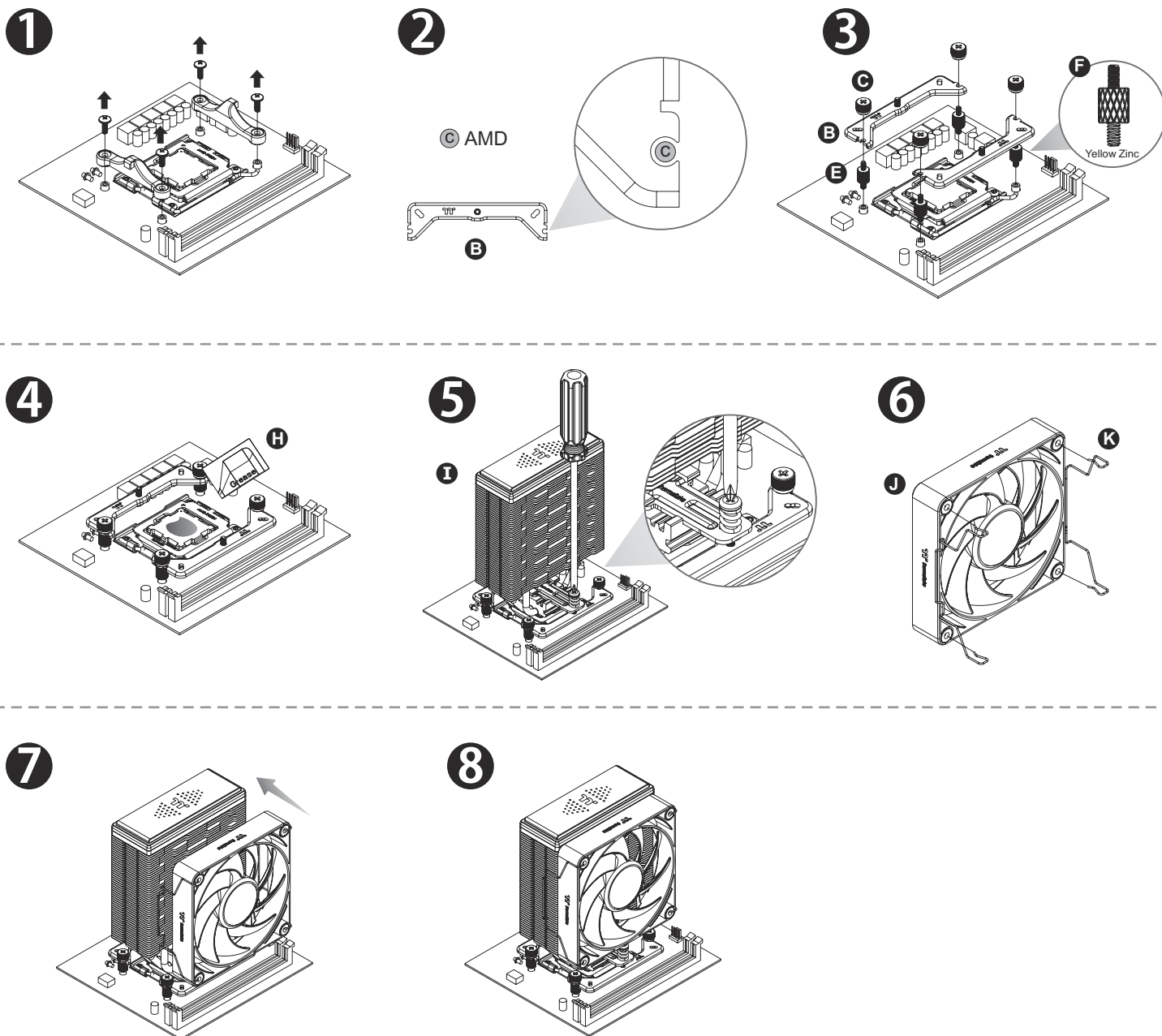

## Fan & MB SYNC Installation Guide

**CAUTION** Please power off the PC and check the Positive and Negative ends on the connector before connecting the cable to mainboard. Connecting the wrong end can damage the fans.

