

Hardware Quick Reference

LANCOM GS-2326+

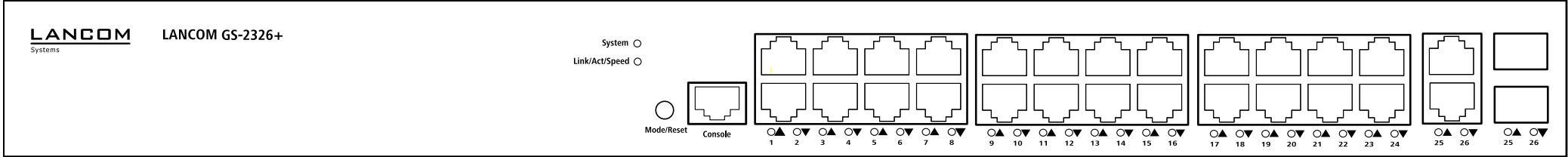

- ① **Configuration interface**
Connect the serial interface (Console) via the included serial configuration cable to the serial interface of the device you want to use for configuring / monitoring the switch.
- ② **TP Ethernet interfaces**
Use Ethernet cables to connect the interfaces ETH 1 to ETH 24 to your PC or a LAN switch.
- ③ **TP Ethernet interfaces (combo ports)**
Use Ethernet cables to connect the interfaces ETH 25 and ETH 26 to your end device or another LAN switch.

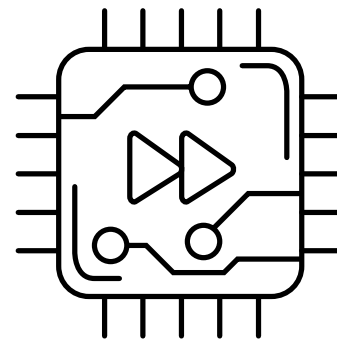
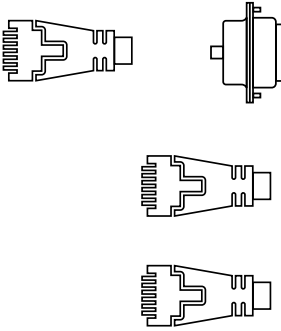

- ④ **SFP interfaces (combo ports)**
Insert suitable LANCOM SFP modules into the SFP combo ports 25 and 26. Choose cables which are compatible with the SFP modules and connect them as described in the module's documentations.
- ⑤ **Power connector and grounding point (device back side)**
Supply power to the device via the power connector. Please use the IEC power cable supplied (separately available for WW devices).
- ⑥ **ATTENTION:** High touch current possible! Connect to earth before connecting the power supply.

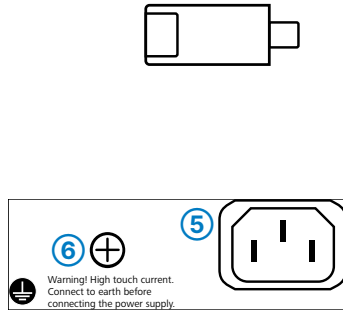

Before initial startup, please make sure to take notice of the information regarding the intended use in the enclosed installation guide!

Operate the device only with a professionally installed power supply at a nearby power socket that is freely accessible at all times.



Please observe the following when setting up the device

- The power plug of the device must be freely accessible.
- For devices to be operated on the desktop, please attach the adhesive rubber footpads
- Do not rest any objects on top of the device
- Keep all ventilation slots on the side of the device clear of obstruction
- Mount the device into a 19" unit in a server cabinet using the provided screws and mounting brackets.
- Please note that support service for third-party accessories is excluded.

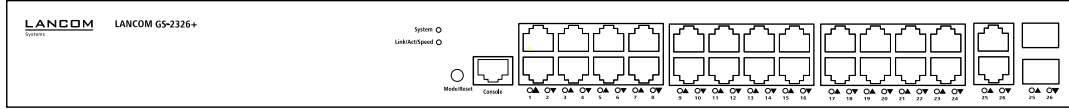

① System / Link/Act/Speed	③ TP Ethernet ports
System: off	Off
System: green	Green
Link/Act/Speed: green	Orange
② Mode/Reset button	④ SFP ports
Short press	Off
5 seconds pressed	Green
10 seconds pressed	Orange
Device powered off	Port inactive
Device operational	Link 1000 Mbps
Port LEDs show link / activity status or port speed	Link ≤ 100 Mbps
	Link ≤ 100 Mbps

Hardware	
Power supply	Internal power supply unit (100–240 V, 50–60 Hz)
Power consumption	Max. 26 W
Environment	Temperature range 0–40 °C, humidity 0–95 %; non-condensing
Housing	Robust metal housing, 1 HU with mounting brackets for 19" installation, 442 × 44 × 170.3 mm (W × H × D)
Number of fans	None; fanless Design, no rotating parts, high MTBF
Interfaces	
ETH	24 TP Ethernet ports 10 / 100 / 1000 Mbps 2 Combo ports (TP/SFP) 100 / 1000 Mbps (SFP) and 10 / 100 / 1000 Mbps (TP) 26 concurrent ports in total
Console	Serial configuration interface / COM port: 115,200 baud
Package content	
Mounting brackets	Two 19" brackets for rack mounting
Cables	1 IEC power cord 230 V, 1 serial configuration cable 1.5 m